

Notes:
 This drawing is copyright (C). The reproduction of this drawing is expressly prohibited by Cumming Anderton.
 This drawing may be subject to Local Authority approval, manufacturer's recommendations and further detailed design.
 Dimensions and conditions shall be verified on site. Any discrepancies between this drawing and site conditions shall be brought to the attention of the architect for resolution prior to placing orders or construction.
 This drawing should not be scaled.
 This drawing is to be read in conjunction with the following drawing nos:

North:  Office use only:

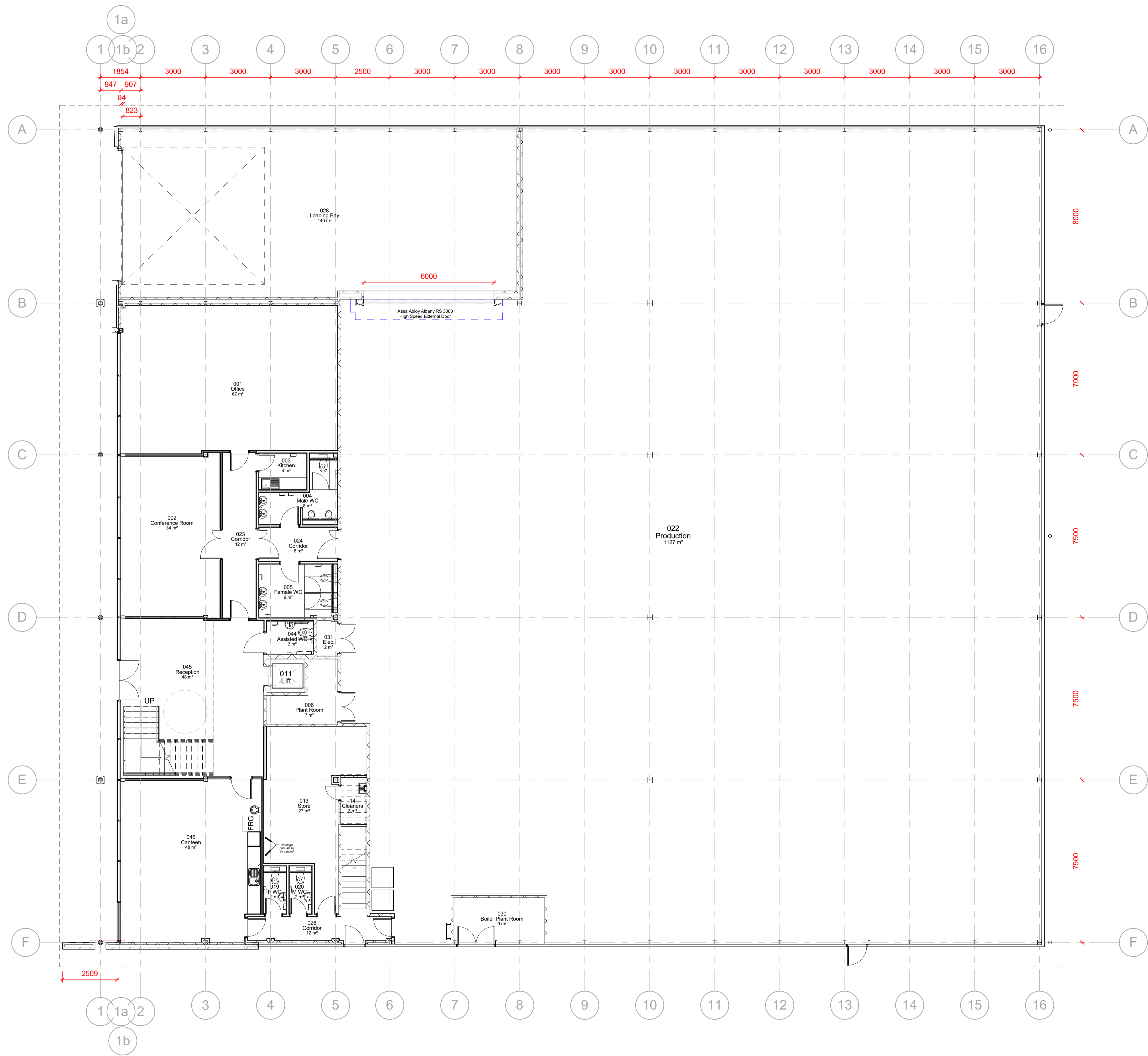
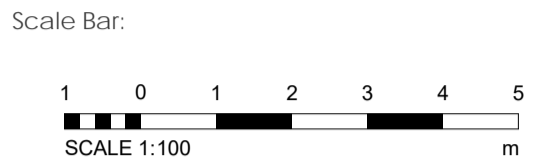

- Q 12.05.16 - Room 013 changed from 'Gym' to 'Store'
- Alterations to kitchen layout (Room 003)
- Staircase in Room 007 moved 63mm towards GL E
- P 15.04.16 - Alterations to location of internal wall between Room 022 and corridor 026.
- O 08.04.16 - Alterations to door types/openings
- N 05.04.16 - Revision Clouded
- M 02.03.16 - Outline of roof added, showing overhang dimensions
- L 25.02.16 - Alterations to grid layout and column sizes.
- K 18.02.16 - Revisions to layout and grid.
- Relocation of cleaners store.
- J 18.01.16 - Revisions to plant room and AWC
- I 03.12.15 - Post tender alterations

Rev notes:
 Project:
New Manufacturing Centre
Tube and Bracket Company
Middleton Cheney
Proposed Ground Floor Plan

Scale:
1 : 100 @ A1
 Date:
28/07/2015
13:48:25
 Job no:
15-946
 Drawn by:
SK
 Drawing no:
210
 Revision:
Q

1 00 Ground Floor Plan
 1 : 100